



ADDED VALUES

ADDED VALUES

STANDARD [S]

Sanded without additional features.

BRUSHED [B]

Brushed floors exude a rustic and homely appearance by emphasizing on the natural structure of the wood. The touch of the wood is enhanced by steel brushing the floor boards, which gives it a lively structure, accentuates light and adds extra perspective to your floor.

HAND-SCULPTURED [H]

Craftsmen using century-old techniques to create the charm and ambience of hand-crafted, custom-made flooring. In this way each new plank is truly unique, adding character and originality to your lacquered floor; characteristics which traditional flooring does not offer.

FINISHINGS

LACQUERED

For some, the maintenance of wooden flooring can be quite a burden. In order to meet the demand for easy maintenance. ReTree offers a range that is characterized by its application of a multitude of high quality UV coatings. The result is an incredible scratch and wear resistance. Thanks to the ability to control the brilliance of the lacquer, ReTree still realizes the natural artistic preferences of the wood.

OILED

Oil finishing is an answer to the desire of returning to nature. It allows the wood to breath and live outside the tree by nurturing every single vessel of the wood. The range of ReTree 's oil finishes brings out the natural beauty of the wood and protects it from harmful exterior elements. The finishing oil is an environmental friendly product based on vegetable oil. It penetrates the wood surface easily which ensure a hard-wearing surface.



» White



» Natural



» Grey



» Chocolate



» Cognac

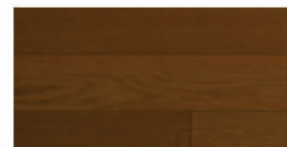

» Walnut

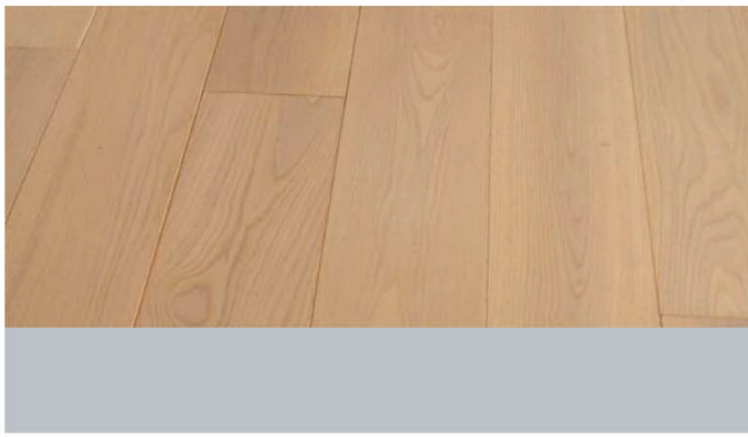

SOLID FLOORS

SPECIFICATIONS

Commodity:	solid oak flooring - T&G
Wood species:	100% oak [Quercus]
Dimensions:	see table below
Moisture content:	± 10%
Finishing:	unfinished, lacquered, oiled
Microbevel:	G00 (unfinished and hand oiled only), G02, G04
Installation:	tongue & groove
Grading*:	prima [P _A], rustica [R _A], collecta [C _A]
Density:	± 700 kg/m ³

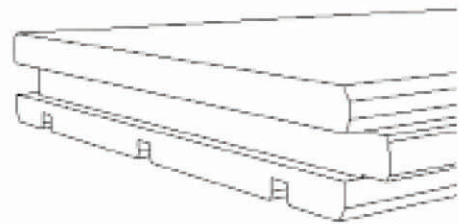

DIMENSIONS

thickness		width		min length		max length		average length		grading*		
mm	inch	mm	inch	mm	feet	mm	feet	mm	feet	P _A	R _A	C _A
14	1/2	90	3 1/2	400	1	1200	4	≥ 650	≥ 2 1/4	X	X	X
14	1/2	125	5	400	1	1200	4	≥ 650	≥ 2 1/4	X	X	X
18	3/4	125	5	400	1	1800	6	≥ 786	≥ 2 1/2			X
18	3/4	150	6	400	1	1800	6	≥ 786	≥ 2 1/2			X

* Please find our quality grading on the backside

PACKAGING

Dimensions	m ² /box	ft ² /box	box/pallet	m ² /pallet	ft ² /pallet	kg/pallet	pallet/cont	kg/cont	m ² /cont	ft ² /cont
14 x 90 x 400 - 1200mm	1,30	14	38	49,25	530	462,13 ^A	26	12105	1280,45	13782 ^{3/4}
14 x 125 x 400 - 1200mm	0,90	9 ^{3/4}	55	49,50	532 ^{3/4}	525,35 ^A	26	13659	1287,00	13853 ^{1/4}
18 x 125 x 400 - 1800mm	1,38	14 ^{3/4}	80	110,00	1184	1479,56 ^B	10	14796	1100,00	11840 ^{1/4}
18 x 150 x 400 - 1800mm	1,65	17 ^{3/4}	65	107,25	1141	1443,82 ^B	10	14438	1072,50	11544 ^{1/4}

Pallet A: 1250mm [L] x 780mm [W] x 1100mm [H] - 25kg

Pallet B: 1900mm [L] x 1100mm [W] x 1100mm [H] - 50kg



►► Box



►► Pallet

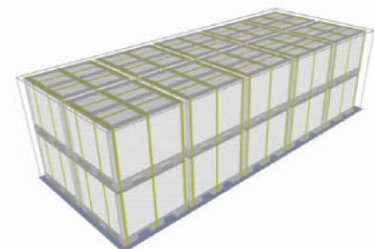

►► Container



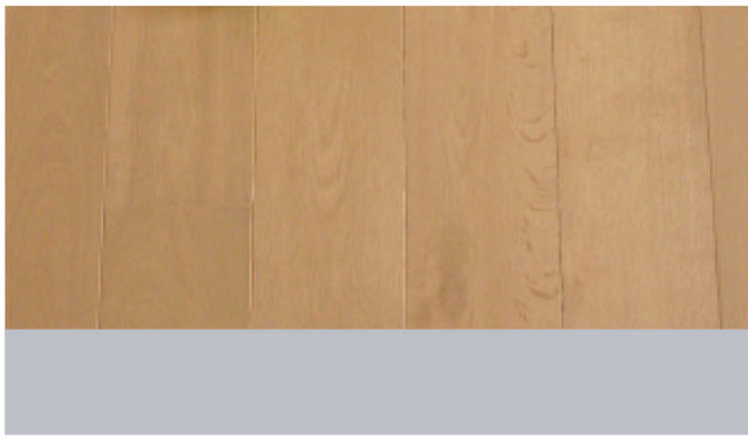

SOLID QUALITY

GRADING

PRIMA [P_A]

Allowed: face has a uniform colour and is practically free of defects; small healthy knots with max diameter of 5,4 mm; board ≤ 125 mm: max 2 knots/meter; board > 125mm: max 3 knots/meter.

Not allowed: sapwood, heartwood, blue stain and cracking.

RUSTICA [R_A]

Allowed: face may contain small streaks, burls, black lines, black coloured knots and tight knots; knots with max diameter of 25 mm; colour variation within the parcel; board ≤ 125 mm: max 4 knots/meter; board > 125 mm: max 6 knots/meter.

Not allowed: sapwood, big streaks and heartwood.

COLLECTA [C_A]

Consistence: Collecta is the unselected grade which generally contains 30% of Prima boards, 40% of Rustica boards and 30% of that, which allowed : face may contain sapwood, big streaks, burls, mineral lines, blue stains, heartwood, colour repaired knots and repaired end cracks; board ≤ 125 mm: knots with max diameter of 50 mm; board > 125 mm: knots with max diameter of 36 mm; sapwood: 30% of width and length while not allowed: pinworm holes and rotten wood.

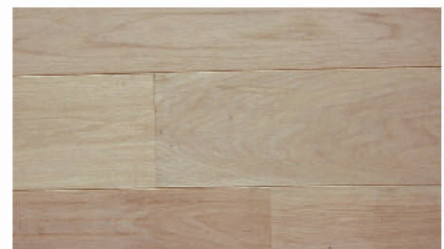

▶▶ prima grading

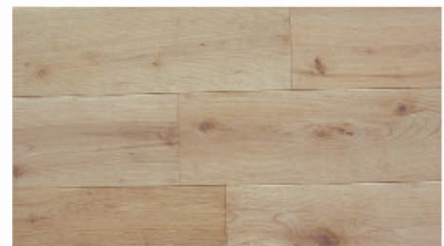

▶▶ rustica grading

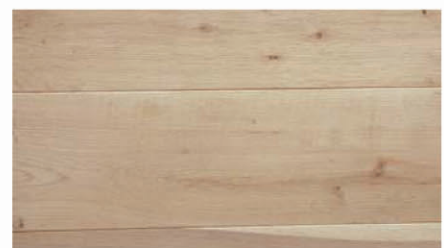

▶▶ collecta grading

TECHNICAL SPECIFICATIONS [ALL GRADES]

Tolerance on length:	1 mm
Tolerance on thickness:	0,1 mm [board ≥ 14 mm thick] 0,2 mm [board ≥ 18 mm thick]
Moisture content:	± 10%
Bending:	< 2 mm bending/ 1 running meter
Cupping:	not allowed

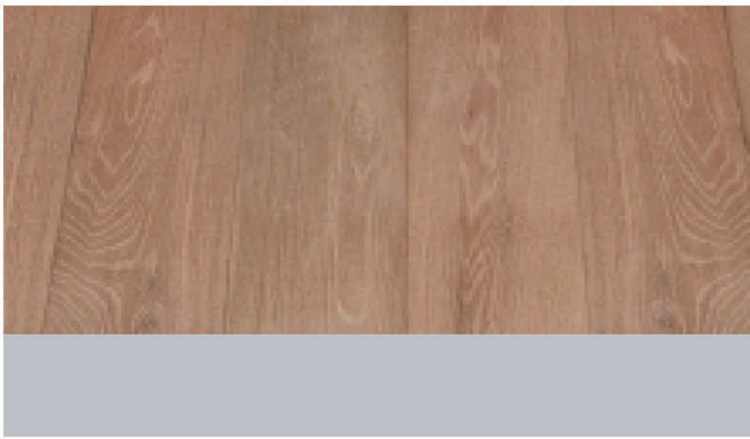

ENGINEERED FLOORS

SPECIFICATIONS

Commodity:	engineered oak flooring - T&G
Top layer:	2,5 - 3 - 5 mm oak [Quercus] veneer
Base:	7,5 - 11 - 15 mm plywood
Dimensions:	see table below
Moisture content:	± 10%
Finishing:	unfinished, lacquered, oiled
Microbevel:	G00 (unfinished and hand oiled only), G02, G04
Installation:	tongue & groove
Grading*:	primo [P _o], rustico [R _o], terro [T _o],
Density top layer:	± 700kg/m ³
Environment:	glue content reaches E1 standard

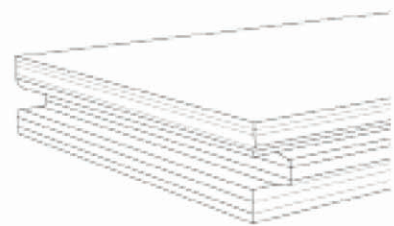

DIMENSIONS

thickness		width		min length		max length		average length		grading*		
mm	inch	mm	inch	mm	feet	mm	feet	mm	feet	P _o	R _o	T _o
7,5 + 2,5	1/4	150	5 3/4	400	1	1830	6	1464	4 ^{3/4}		X	
11 + 3	1/2	189	7 1/2	400	1	1830	6	1569	5 ^{1/4}	X	X	X
15 + 5	3/4	189	7 1/2	400	1	1830	6	1464	4 ^{3/4}	X	X	X
15 + 5	3/4	220	8 1/2	400	1	2200	7 1/4	1760	5 ^{3/4}		X	

* Please find our quality grading on the backside

PACKAGING

Dimensions	m ² /box	ft ² /box	box/pallet	m ² /pallet	ft ² /pallet	kg/pallet	pallet/cont	kg/cont	m ² /cont	ft ² /cont
10 x 150 x 400 - 1830mm	2,20	23 1/2	66	144,94	1539 1/4	968,89 ^B	12	11627	1739,23	18721
14 x 189 x 400 - 1830mm	2,08	22 1/2	60	124,51	1340 1/4	1308,58 ^B	12	15703	1494,16	16083
20 x 189 x 400 - 1830mm	1,38	14 3/4	59	81,63	878 3/4	1228,67 ^B	12	14744	979,50	10543 1/4
20 x 220 x 400 - 2200mm	1,936	20 3/4	48	92,93	1000 1/4	1391,88 ^C	10	13919	929,28	10002 3/4

Pallet B: 1900mm [L] x 1100mm [W] x 1100mm [H] - 50kg

Pallet C: 2220mm [L] x 1100mm [W] x 1100mm [H] - 50kg



►► Box



►► Pallet

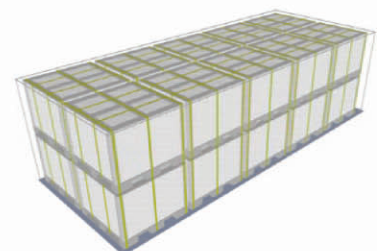

►► Container



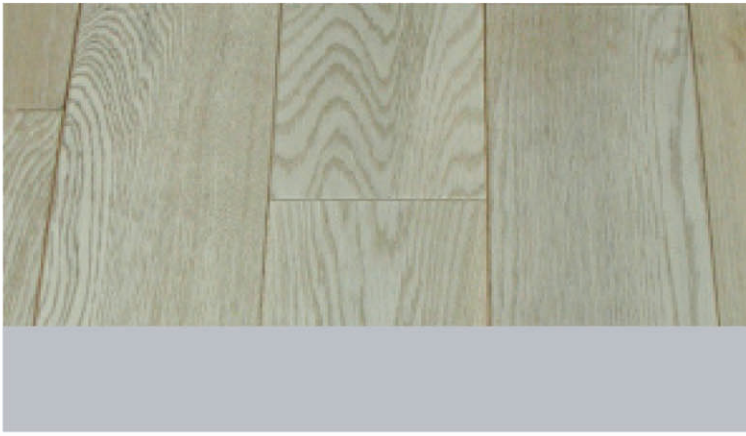

ENGINEERED QUALITY

GRADING

PRIMO [P_o]

Allowed: light color variation; all knots are well repaired; unlimited knots with a max diameter of 15 mm.

Not allowed: dark wood, loose knots, end & surface cracks, sapwood, heartwood; mineral streaks, blue stains, insect holes, rotten wood, sticker marks, bark pockets, delamination, air bubbles and open defects.

RUSTICO [R_o]

Allowed: color variation; no limits on small knots and all knots well repaired; max 2 sound knots with max diameter of 45 mm on every 1830 mm; sound edge knots. Loose knots allowed up to 30 mm; end cracks, max 10%, up to 100 mm, completely filled with a max width of 3 mm; surface cracks with max width of 2 mm, completely filled; mineral streaks, dark veins.

Not allowed: dry spots, dark wood, sapwood, heartwood, blue stains, insect holes, sticker marks, bark pockets, rotten wood, delamination, air bubbles and open defects.

TERRO [T_o]

Allowed: color variation; no limit on sound knots and diameter of knots; loose knots allowed up to 50 mm, but completely repaired; repaired end & surface cracks; max 15% sapwood; mineral streaks, heartwood, bark pockets.

Not allowed: blue stains, insect holes, sticker marks, rotten wood, delamination and air bubbles.



▶▶ primo grading

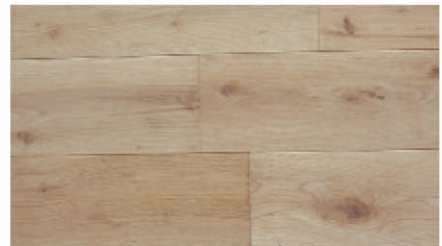

▶▶ rustico grading



▶▶ terro grading

TECHNICAL SPECIFICATIONS [ALL GRADES]

Moisture content:	± 10%
Positive bending:	< 2.5 mm / 1200 mm < 5 mm / 1830 mm
Negative bending:	not allowed
Cupping:	not allowed
Tolerance on length:	+/- 1 mm
Tolerance on width:	+/- 0.2 mm
Tolerance on thickness:	+/- 0.1 mm (board ≤ 14 mm thick) +/- 0.2 mm (board ≥ 18 mm thick)

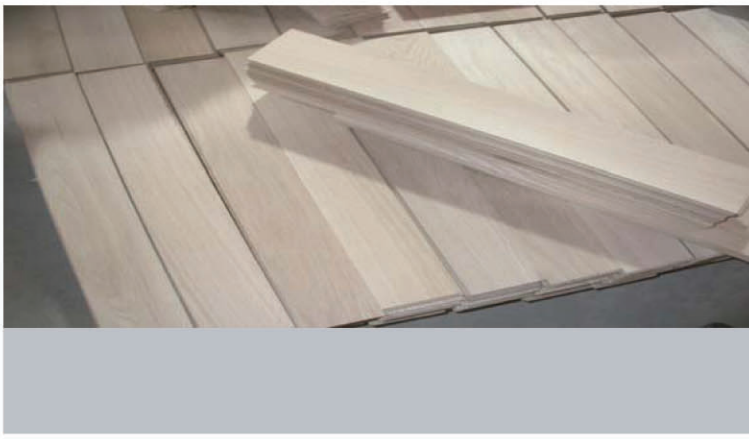

YOUR WARRANTY

Thank you for selecting ReTree interior wooden products.

1. During this limited warranty, your ReTree products are warranted to be free from defects in manufacturing, materials and workmanship.
2. Should the Goods be defective and under the Seller's warranty, ReTree shall be obliged, at its sole discretion, either (i) to replace such Goods, or (ii) to reduce the product price or (iii) to cancel the said contract and take back the Goods. In case such Goods are not longer available, ReTree will ensure replacement by an alternative product of the same quality.
3. In any event the Seller shall not be liable for any loss of processing, loss of production, loss of revenue and/or any incidental or consequential or special loss or damage directly or indirectly sustained by the customer or by any other person whatsoever. Any obligation for damages shall be limited to foreseeable damages only, however, not to exceed the invoiced value of the Goods in respect of which the Seller is in default. It is the customer's responsibility to separate the Goods in default from the Goods conform the contract
4. Upon Delivery of Goods, a complete inspection of the Goods shall be carried out. Any apparent damage to the packaging of the Goods or to the Goods themselves, or any shortage of the quantities shall be noted and communicated promptly to the Seller in writing by fax or legally signed e-mail. The Goods shall be considered automatically accepted upon Delivery if the customer fails to make any comments in writing in respect thereof not later than 15 days after their Delivery. Any claim in respect of any defect, deficiency and/or shortage in quantity of the Goods after this period shall be statute-barred
5. Undetectable defects at Delivery must be notified in writing to the Seller immediately upon discovery, but, in any event, no later than 30 days after Delivery. After this period, during which the customer must thoroughly inspect the Goods, any claim in respect of such defects shall be statute-barred.



WARRANTY

CONDITIONS & EXCLUSIONS

ReTree products are built to be durable and long lasting. There are certain conditions or applications, however, over which ReTree has no control. Defects or problems as a result of such conditions or applications are not the responsibility of ReTree and are NOT covered under this warranty. They include:

- ✓ The Goods have not been fitted in accordance with the instructions.
- ✓ Any misuse, modification or alternation.
- ✓ Normal wear or discoloration of finishes.
- ✓ Environmental conditions or exceeding design standards
- ✓ Natural variations in the colors of the wood or in the texture and grain of wood.
- ✓ This limited warranty does not cover, in any way, problems or damages associated with, caused by, contributed to or aggravated by mold, mildew, fungus or any similar organisms.
- ✓ Wood is a natural product and susceptible to expansion and contraction caused by temperature and humidity variation. The natural characteristics of wood movement cannot be warranted against, as slight shrinking and expansion may occur under certain conditions. These deviations from perfection are not considered flaws. ReTree installations instructions must be followed to minimize the problems.

